

ARENA TO HEALTHCARE CONCEPT (A2HC) – COVID ACUTE ISOLATION UNITS ALTERNATE CARE FACILITY (ACF)

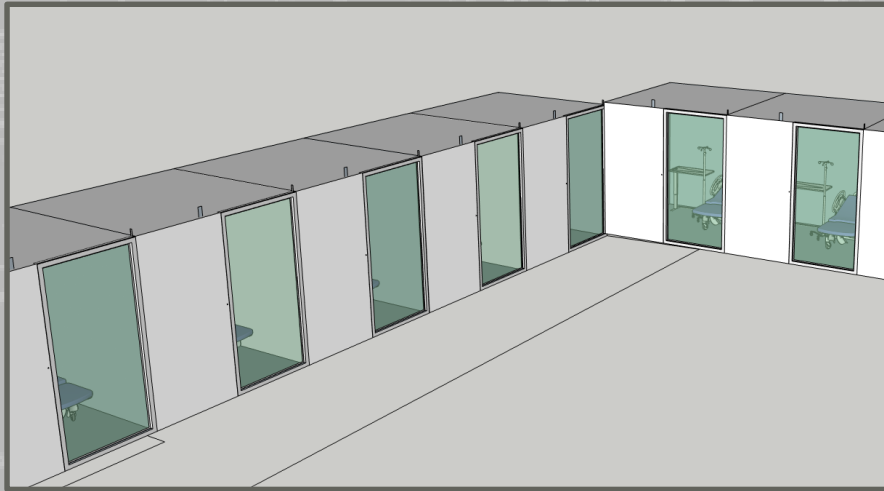

US Army Corps
of Engineers®



A2HC – COVID ACUTE CONTAINER

(PROOF OF PRINCIPLE)



CONCEPT

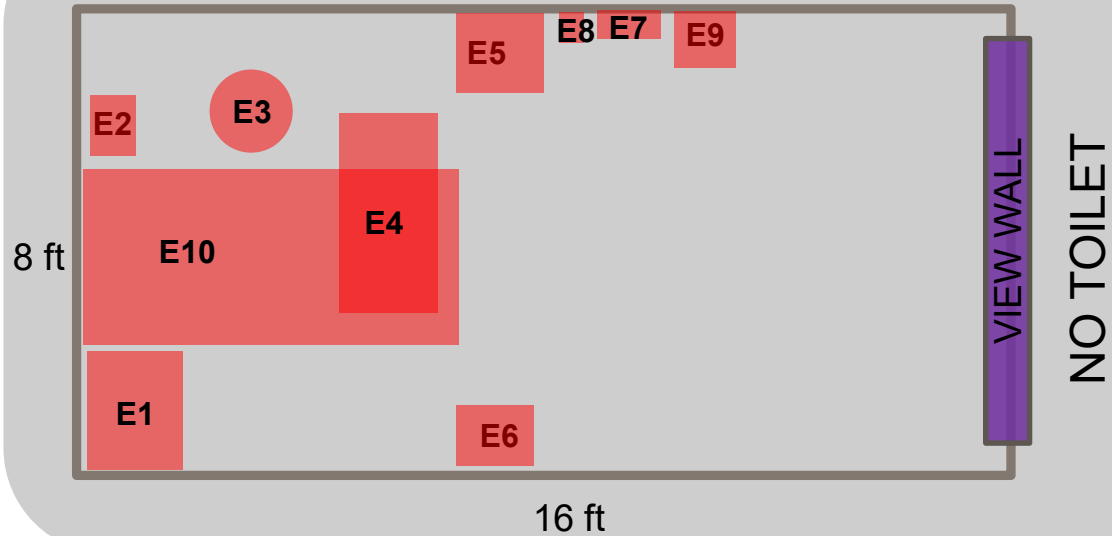

ENGINEERING CHANGES

- Field modified isolation room entry door
- Add louver with gravity damper and balancing damper
- Add exhaust fan with HEPA filtering
- Add mounted lighting
- Add emergency back-up power
- Add electrical and data outlets
- Add washable wall and floor covering

MEDICAL EQUIPMENT

- E1. Ventilator capable: Storage Cabinet
- E2. Telemetry/Pump on IV Stand
- E3. Stool
- E4. Over bed table
- E5. Mobile work station
- E6. Linen hamper
- E7. Sharps/Gloves
- E8. Hand sanitizer station
- E9. Infectious waste
- E10. Patient bed

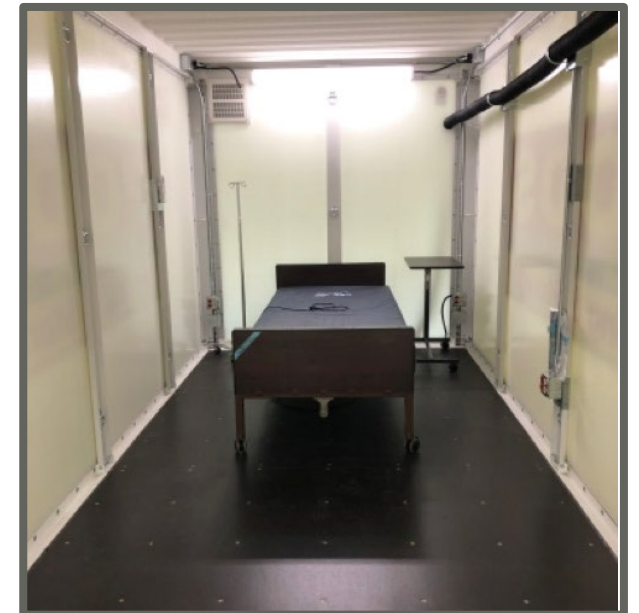



ESTIMATED CONTAINER AVAILABILITY



Note 1: This concept will work with multiple versions of portable moving containers.

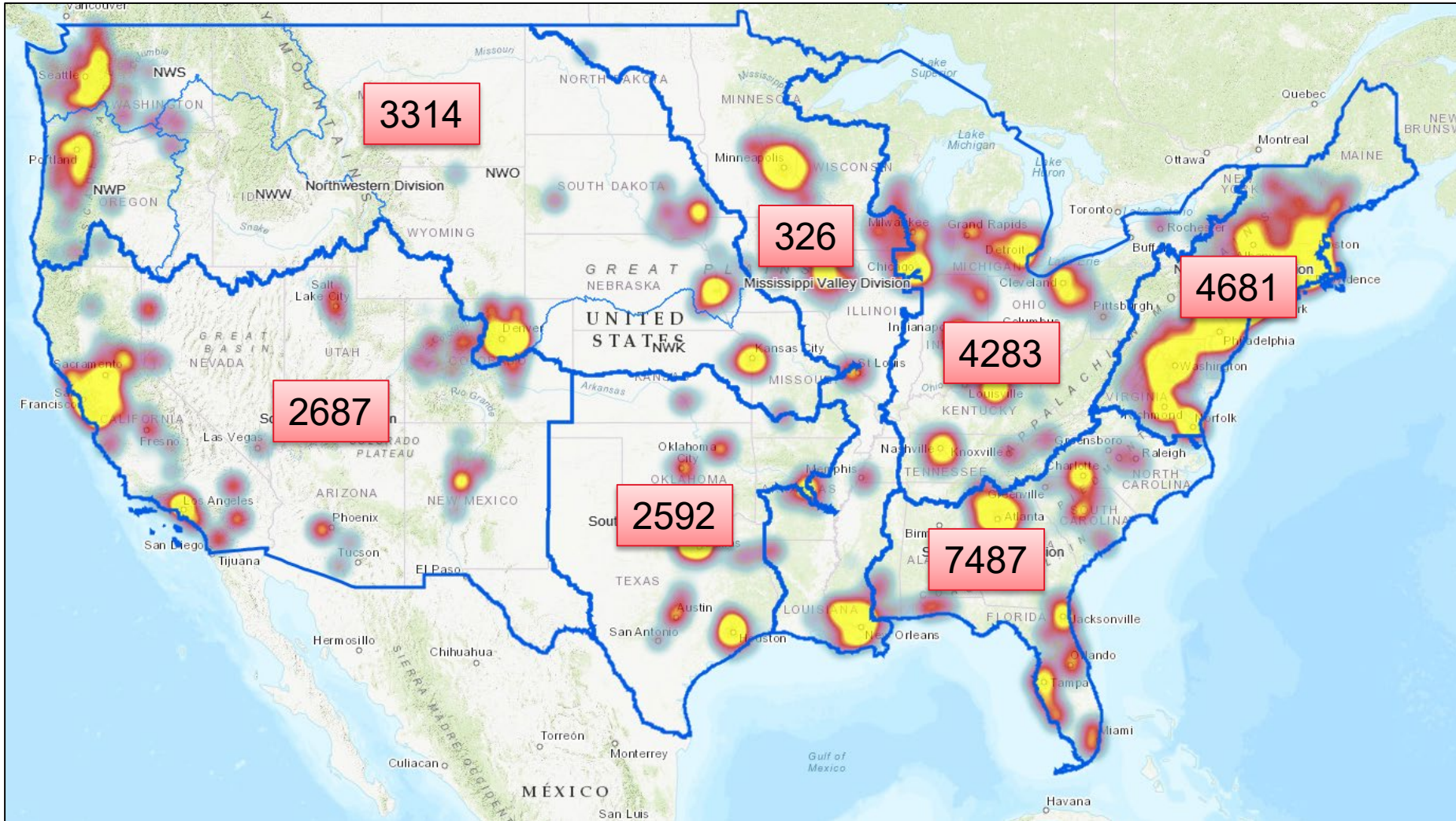

| PODS Inventory by MSC | |
|-----------------------|-------|
| MSC | Total |
| LRD | 4283 |
| MVD | 326 |
| NAD | 4681 |
| NWD | 3314 |
| POD | 29 |
| SAD | 7487 |
| SPD | 2687 |
| SWD | 2592 |

* Verified from 1 source – PODS LLC; working others



8'X12' CONTAINER TYPICAL LAYOUT

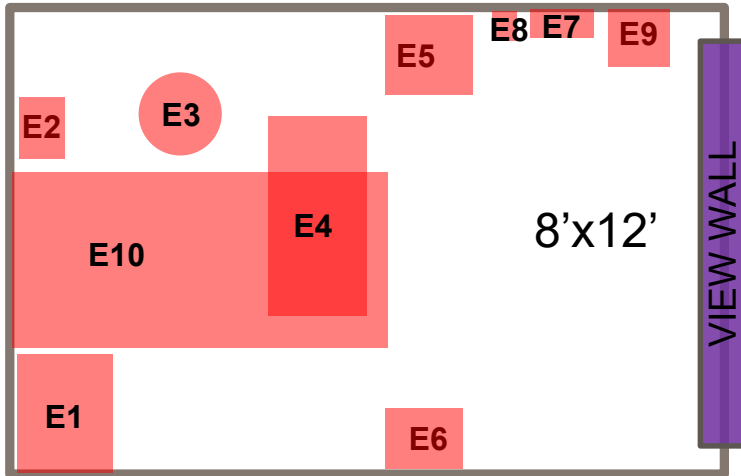

CONCEPT / NOT TO SCALE

ENGINEERING CHANGES

- Field modified isolation room entry door
- Add louver with gravity damper and balancing damper
- Add exhaust fan with HEPA filtering
- Add mounted lighting
- Add emergency back-up power
- Add electrical and data outlets
- Provide washable wall and floor covering

NEW EQUIPMENT

- E1. Ventilator capable: Storage Cabinet
- E2. Telemetry/Pump on IV Stand
- E3. Stool
- E4. Over bed table
- E5. Mobile work station
- E6. Linen hamper
- E7. Sharps/Gloves
- E8. Hand sanitizer station
- E9. Infectious waste
- E10. Patient bed



8'X16' CONTAINER TYPICAL LAYOUT

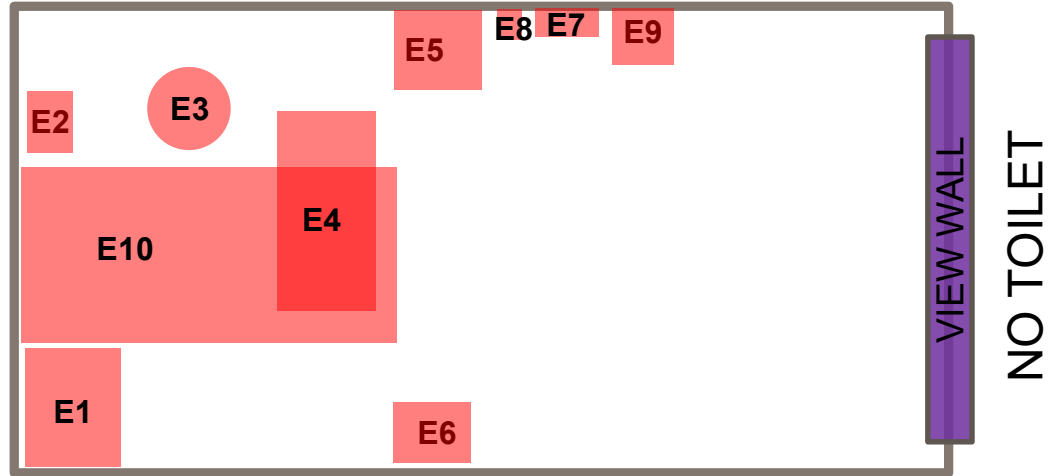

NO TOILET

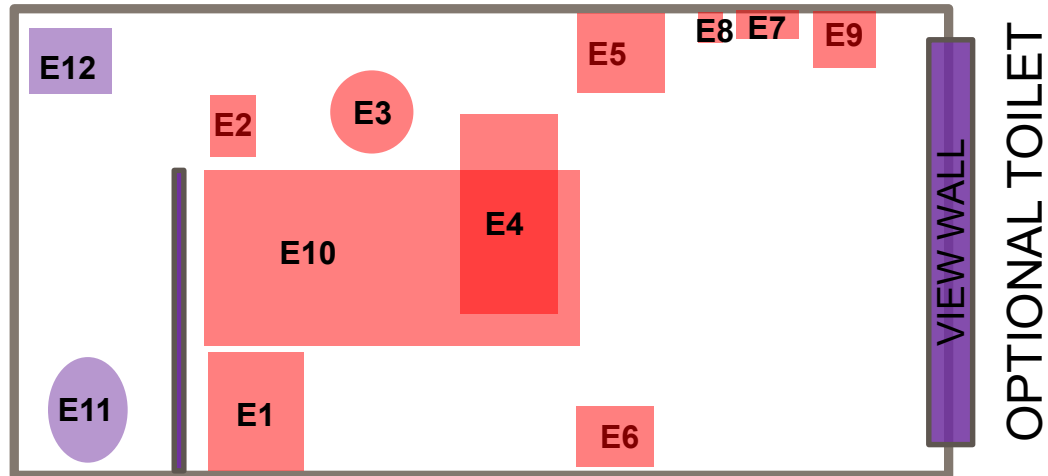

OPTIONAL TOILET

CONCEPT / NOT TO SCALE

ENGINEERING CHANGES

- Field modified isolation room entry door
- Add louver with gravity damper and balancing damper
- Add exhaust fan with HEPA filtering
- Add mounted lighting
- Add emergency back-up power
- Add electrical and data outlets
- Add washable wall and floor covering

NEW EQUIPMENT

- E1. Ventilator capable: Storage Cabinet
- E2. Telemetry/Pump on IV Stand
- E3. Stool
- E4. Over bed table
- E5. Mobile work station
- E6. Linen hamper
- E7. Sharps/Gloves
- E8. Hand sanitizer station
- E9. Infectious waste
- E10. Patient bed
- E11. Patient toilet (optional)
- E12. Patient sink (optional)



UTILITY LAYOUT BACK-TO-BACK (12' OR 16')

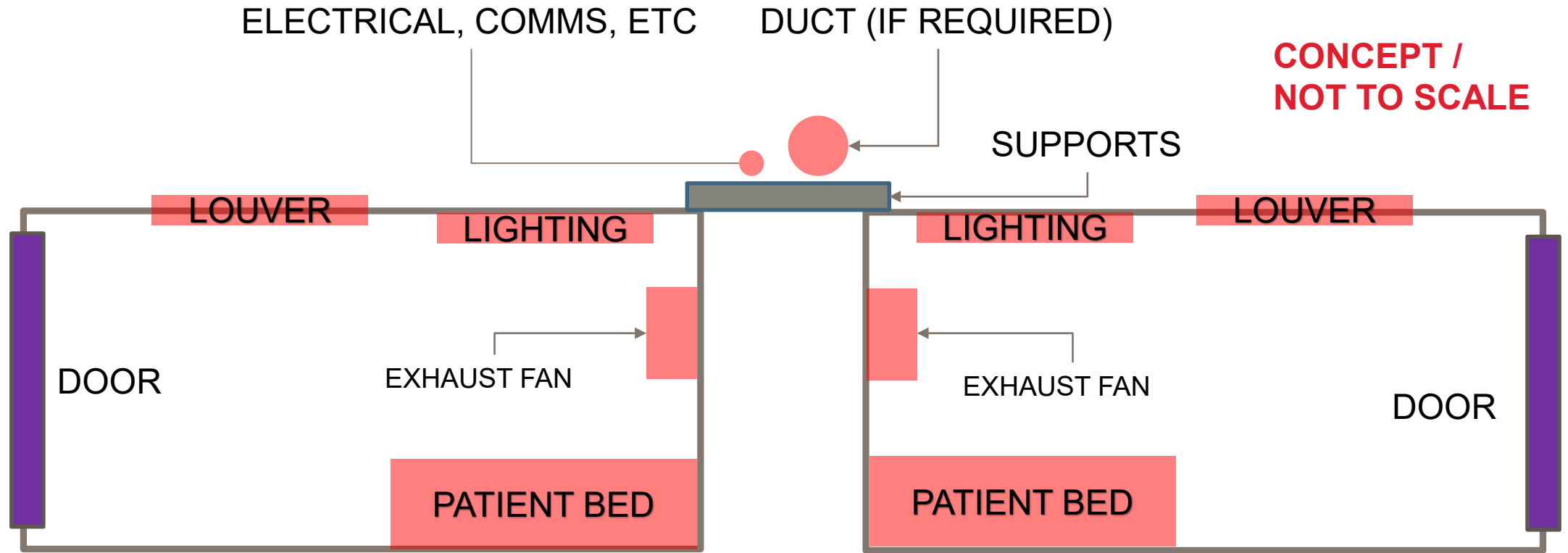

NOTES

- Louver may be placed on ceiling or wall depending on orientation.
- Louver should close when exhaust fan is off.
- Provide manual balancing damper for louver.
- Utility chase may not be required depending on orientation.
- This concept assumes units will be placed inside a conditioned space.



A2HC- BUILT IN PLACE STRUCTURES



- Materials are readily available nationwide
- Fabricated in a local warehouse and transported to the final location
- Units can be fabricated and organized in the warehouse for efficient setup.
- This method allows for an assembly line approach increasing productivity.
- This allows for continuous fabrication with simultaneous setup
- Delivered and setup with the use of flat bed truck with hoist/crane to reduce manhandling of panels.

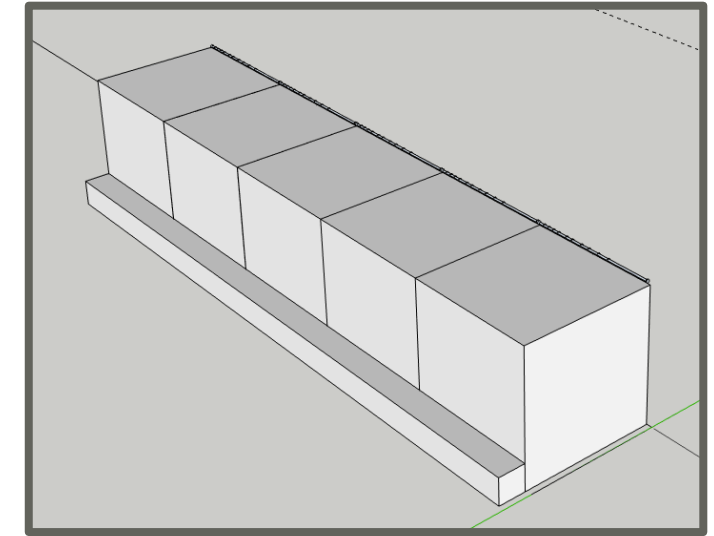
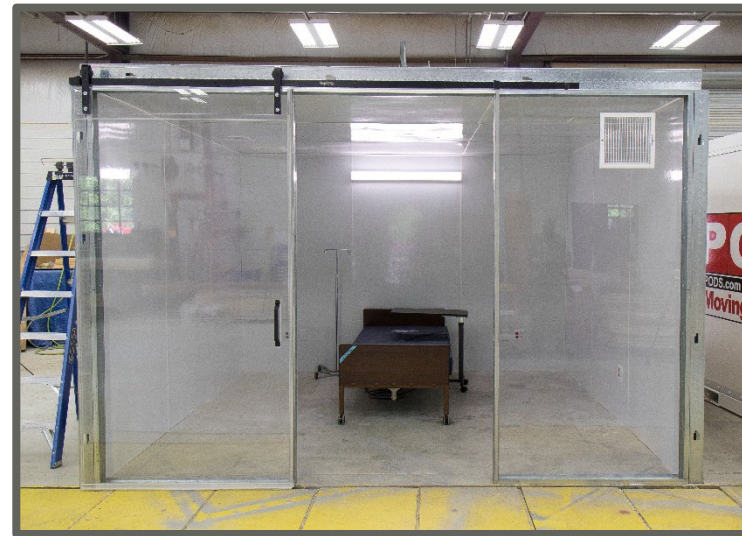
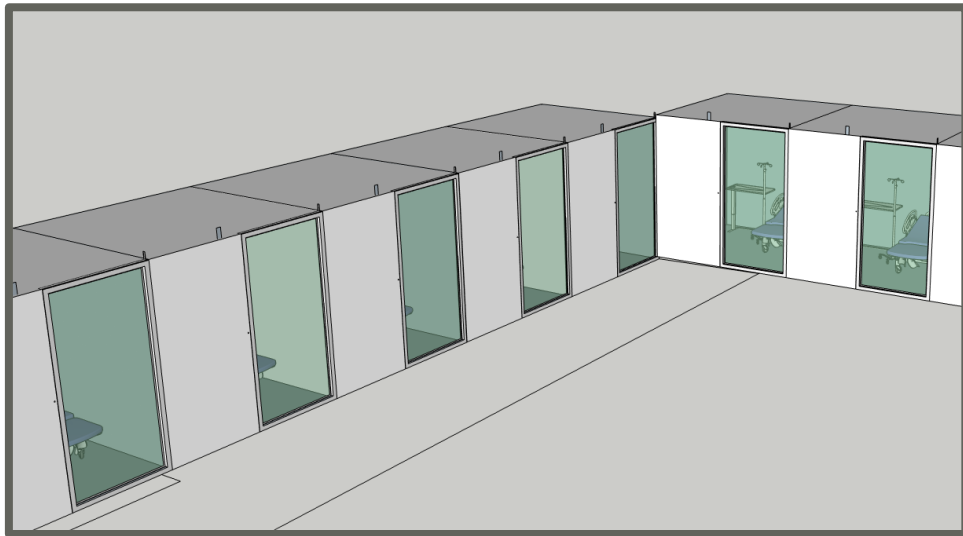
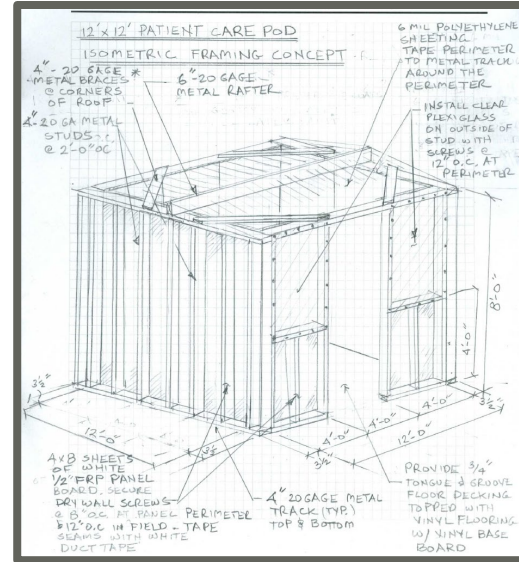

NEW EQUIPMENT: Same as Container concept



SITE REQUIREMENTS FOR ARENA LAYOUTS



ARENA PROVIDED- Field house ice machine

ENGINEERING CHANGES

- All typical floor plan additions
- Build chases for exhaust and utilities
- Construct steps and ramps per unit
- Power/Data distribution

SPECIAL MEDICAL EQUIPMENT

- All typical floor plan additions
- Nurse call
- Patient monitoring
- Portable med gases
- Pharmacy



8'X16' HORSESHOE LAYOUT

- TOTAL: 120 PODS
- TOTAL: 8 NURSE STATIONS

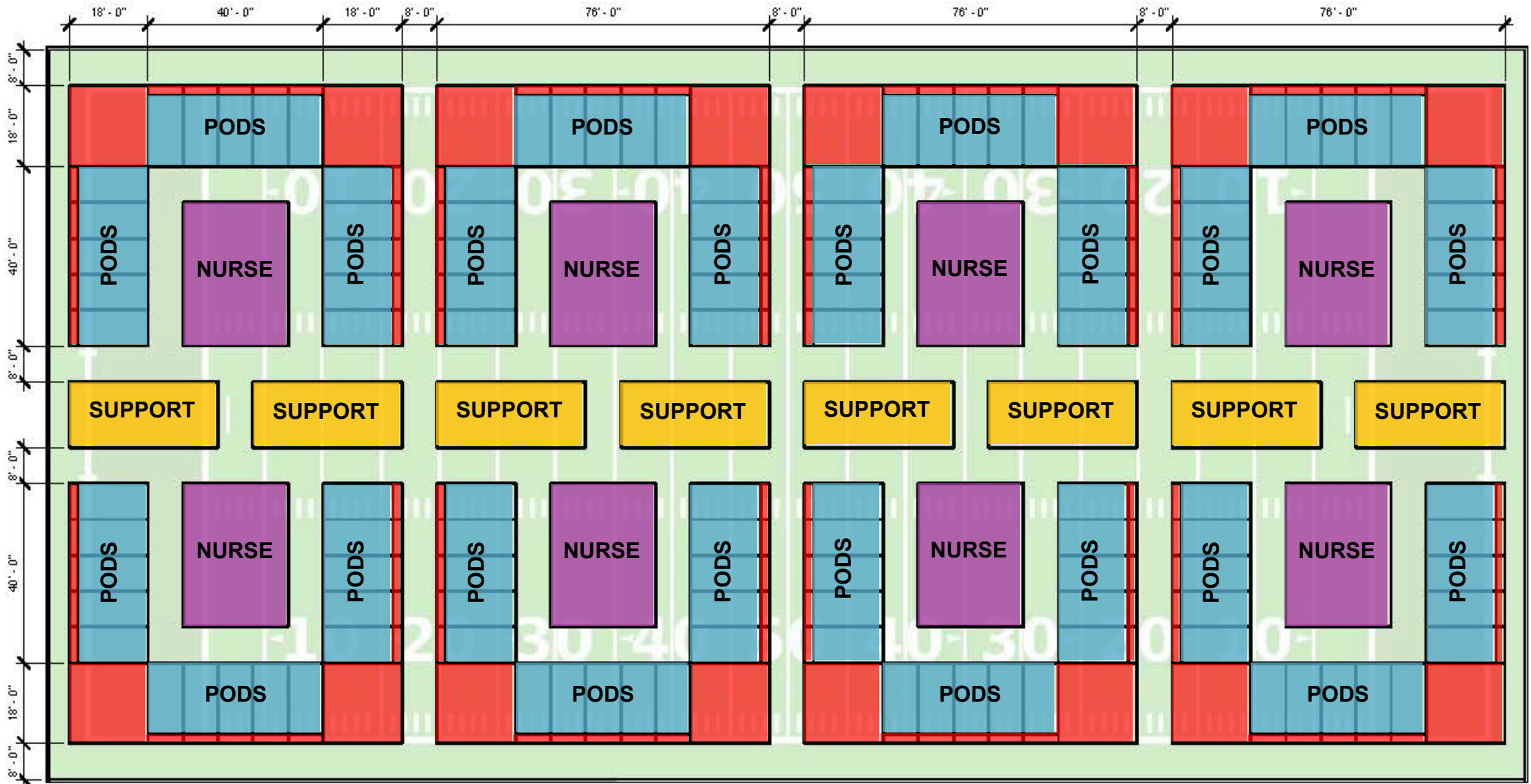

Note: Notional only. Local life safety egress distances and ABA/ADA must be coordinated with AHJ.



8'X16' ROW LAYOUT

- TOTAL: 140 PODS
- TOTAL: 10 NURSE STATIONS

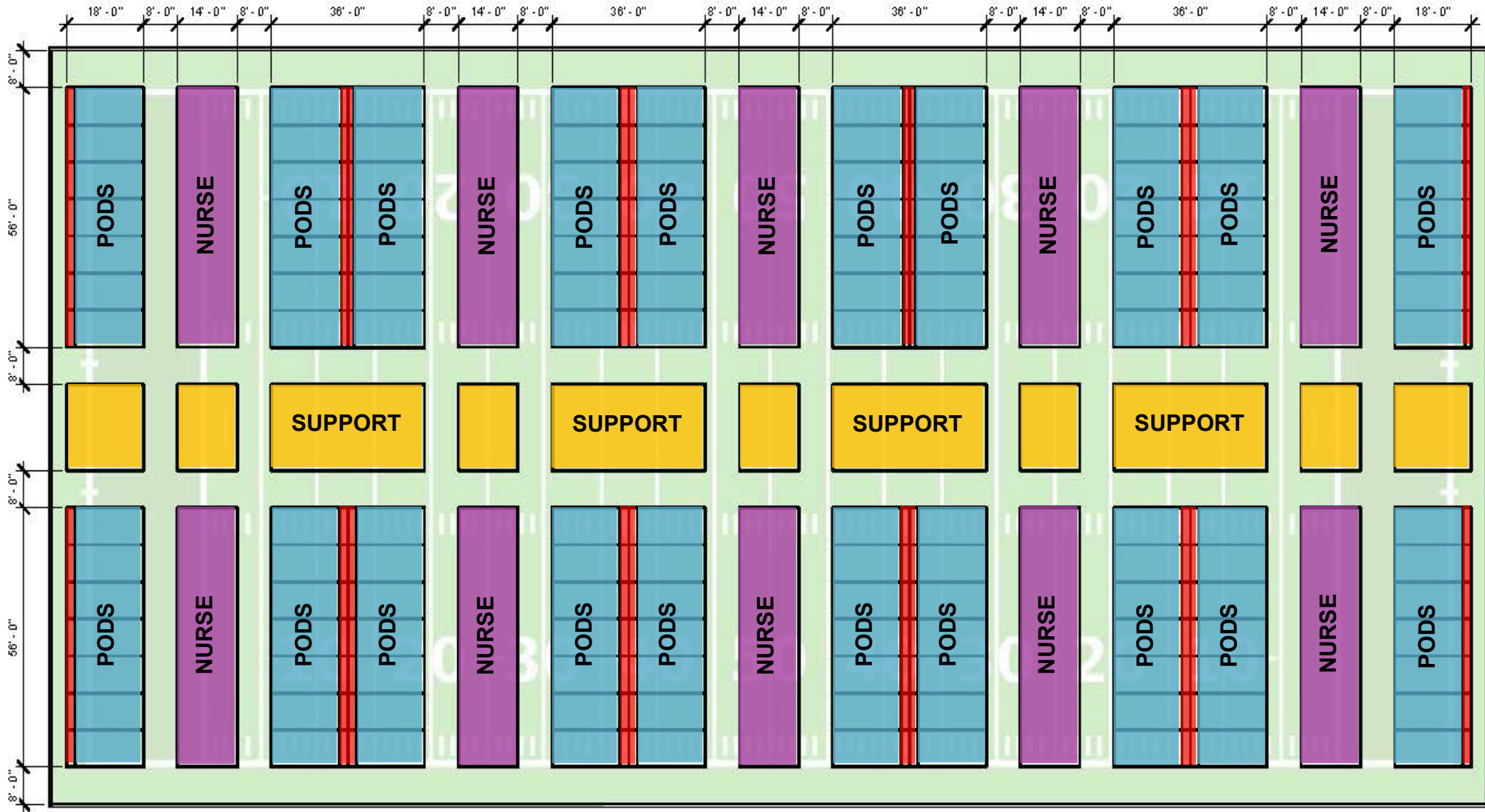

Note: Notional only. Local life safety egress distances and ABA/ADA must be coordinated with AHJ.



8'X12' HORSESHOE LAYOUT

- TOTAL: 136 PODS
- TOTAL: 8 NURSE STATIONS

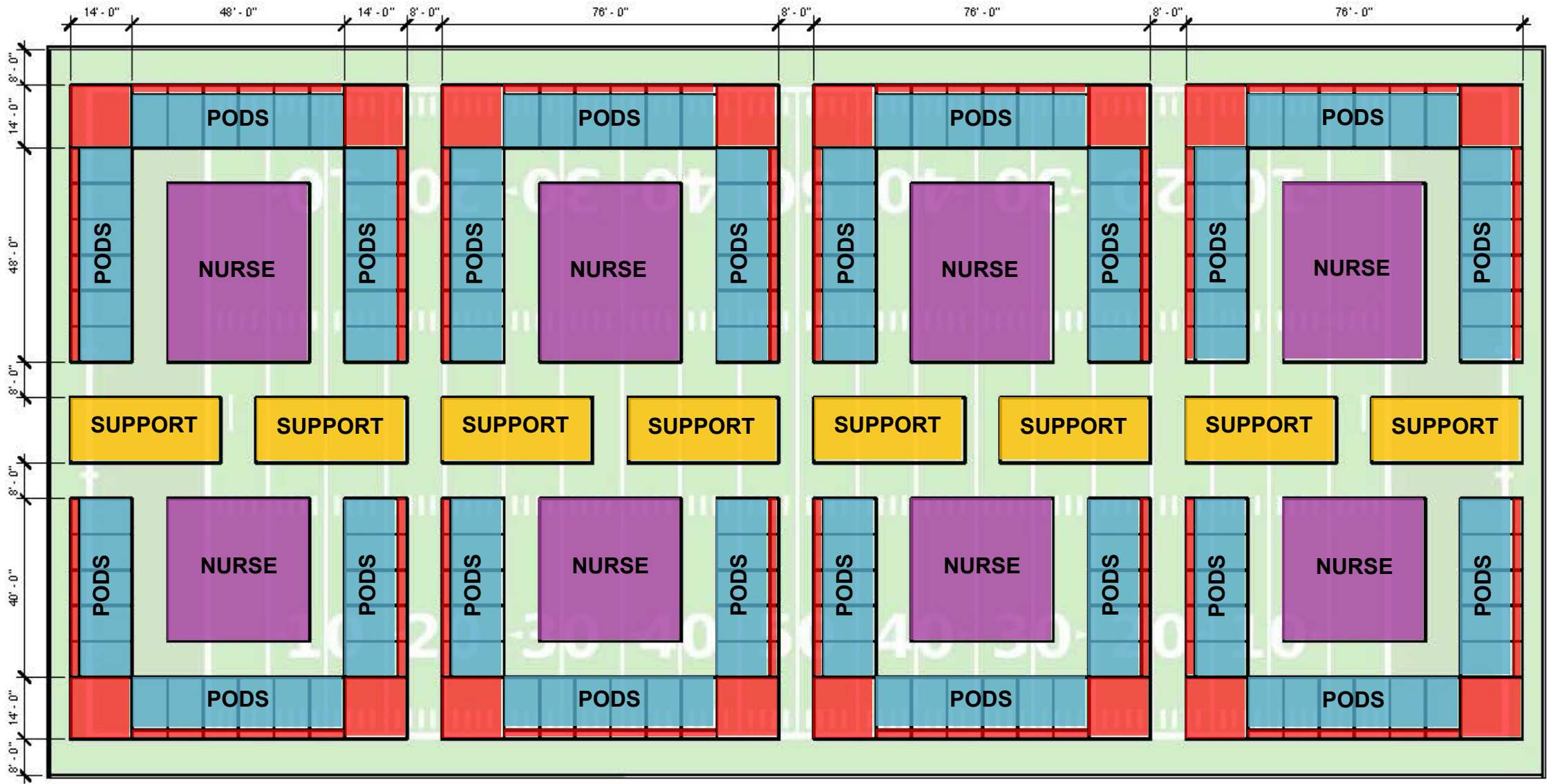

Note: Notional only. Local life safety egress distances and ABA/ADA must be coordinated with AHJ.

